

VERTICAL CROSS SECTION
Typical for two or more units

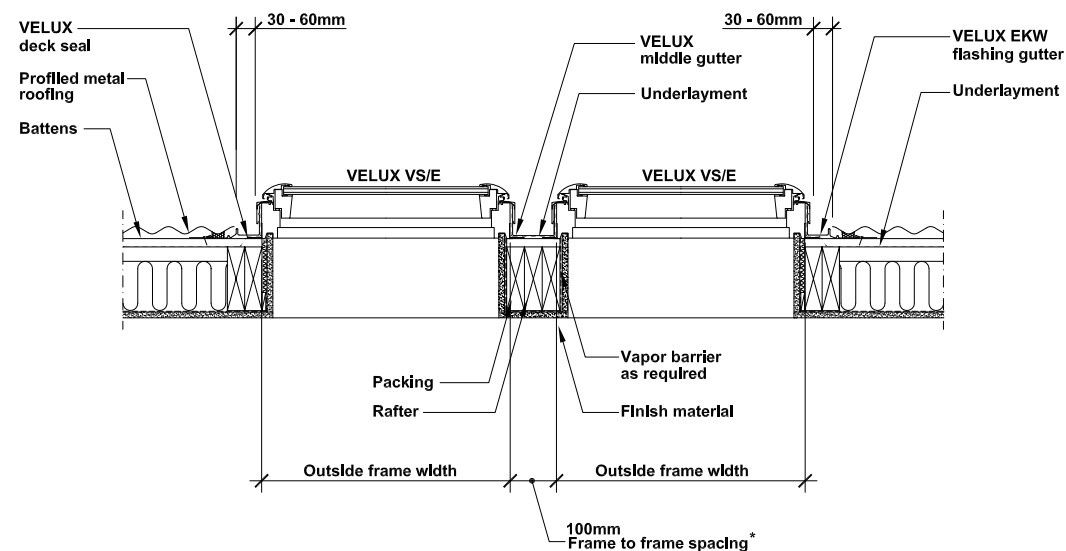

HORIZONTAL CROSS SECTION
Typical for two or more units

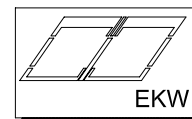
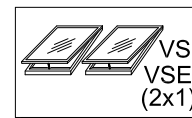

GENERAL NOTES

1. This drawing illustrates a general arrangement layout with recommendations for VELUX skylight installations in a structure with profiled metal sheet roofing. This drawing utilizes the VELUX VS/VSE model skylight.
2. The architectural/structural design and specifications of a skylight installation for tile roof applications are determined and provided by others. The design criteria includes (but is not limited to design loads, structural configurations) structural framing member sizes and material, architectural finishes and integration with the roofing system of the building. VELUX assumes no responsibility or liability in the design, construction and performance of a skylight installation by others.
3. Nail the flashing pieces to the frame and battens - not the roof.
4. Vapor barrier should be used to avoid moisture.

***Horizontal, side x side, Comb flashing**
(frame to frame spacing requirements)

Minimum spacing = 100 mm / Maximum spacing = 100 mm

VELUX

Sky-Product Management

AUSTRALIA PTY. LTD

+612 8565 6000

General Arrangement Layout of (2x1) VELUX VS/VSE Skylights
with EKW Flashing & Profiled Metal Roofing

| Name | Date |
|-------------|----------|
| Drawn by | March 11 |
| Checked by | March 11 |
| Drawing No. | |